

-Make sure to mount the plate on the board so that the arrow on the plate is facing the nose of the board.

-Start by partially tightening the screws for the springs in the middle, then partially tighten the screws on the hinges, and finally, tighten all the screws.

-Check all the screws that fix the the plate to the board regularly, but do not overtighten them.

-Recommended use of a medium strength thread locker like Loctite 243 on all screws.

-For boards with a thicker top sheet and deep inserts it is recommended to use longer screws, M6*12 mm on the hinge mechanisms and M6*10mm in the middle for better screw engagement.

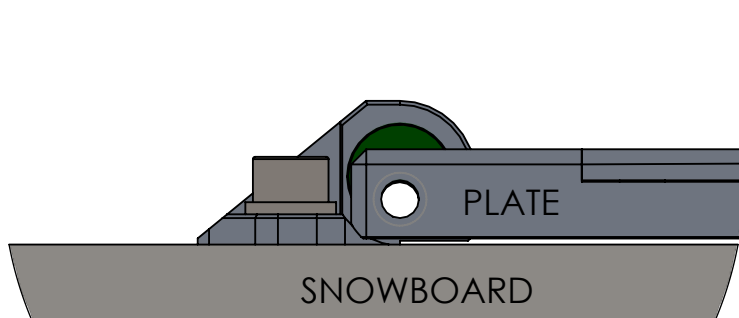

Hinge mechanism side view

-When the plate is correctly mounted on the board, distance between the board and the plate must be less than 1mm. The hinge mechanism must be in bottom position.

